

1-Yedek Parçalar - Pina Mitra Serisi Filtre Yedekleri

Spare Parts - Pina Mitra Serie Filters

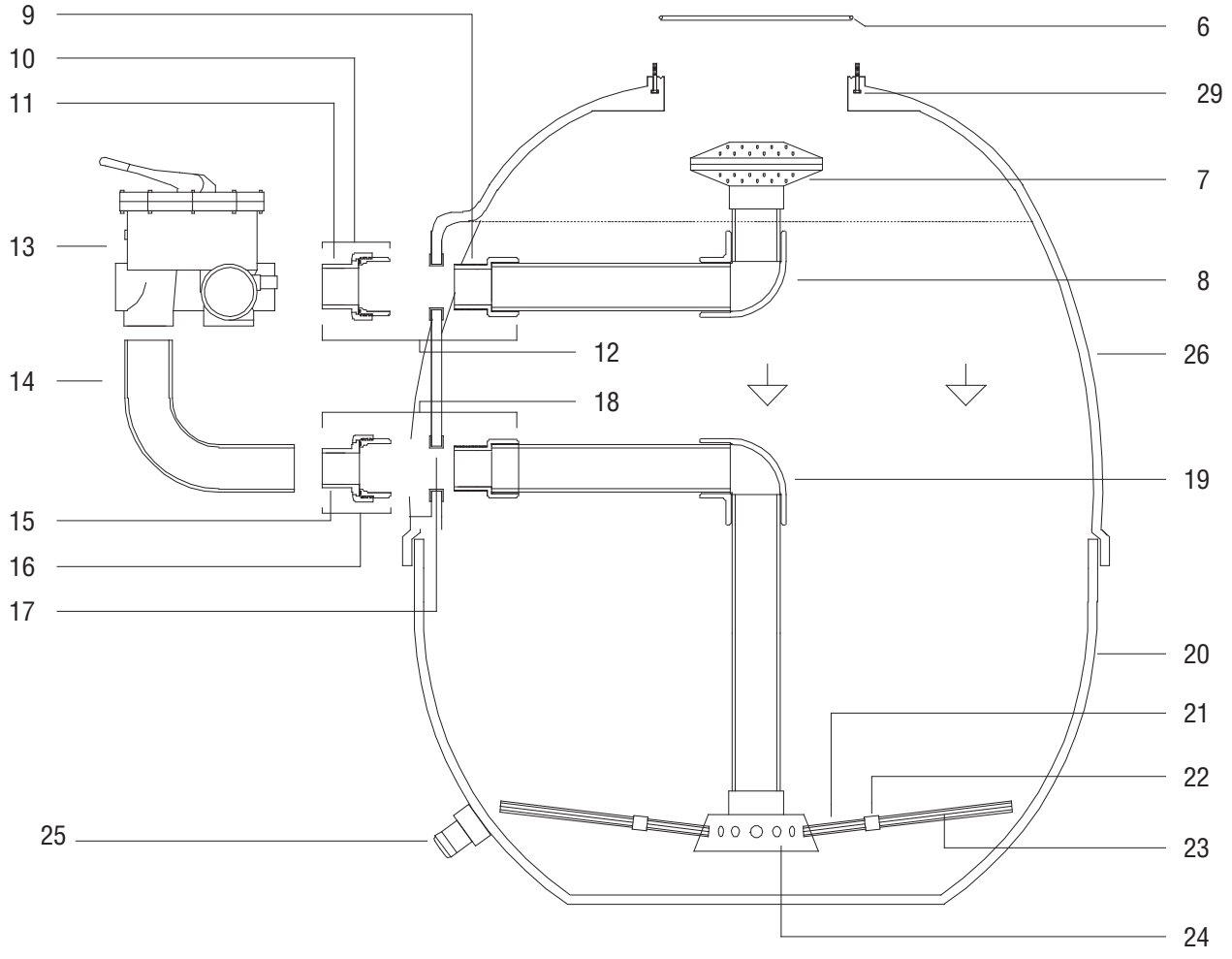
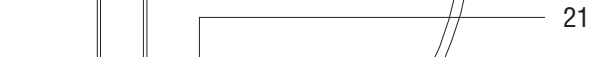
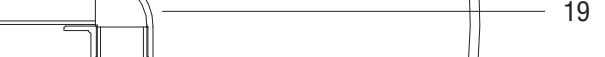
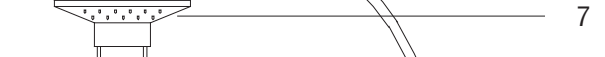
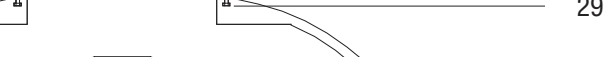
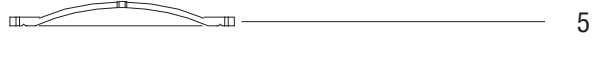
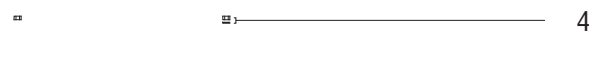
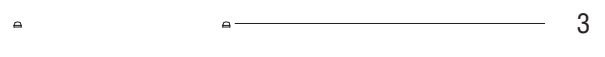

1-Yedek Parçalar - Pina Mitra Serisi Filtre Yedekleri

Spare Parts - Pina Mitra Serie Filters



No	ÜRÜN AÇIKLAMASI	PRODUCT NAME	No	ÜRÜN AÇIKLAMASI	PRODUCT NAME
1	Manometre	Manometer	17	MS 'U' conta	MS 'U' shaped gasket
2	Purijör	Purger	18	MS alt rakor- adaptör bağlantı kiti	MS lower union-adapter kit
3	MS üst kapak somun şapkası	MS cap of lid screw nut	19	MS kollektör tesisatı	MS lateral pipesystem
4	MS üst kapak somunu ve pulu	MS nut and washer for lid screw	20	MS filtre alt gövde	MS bottom body of tank
5	MS üst kapak	MS filter upper lid	21	Pina kollektör kolu 100mm	MS lateral 100mm
6	MS üst kapak O-ring	MS O-Ring of upper lid	22	Pina kollektör kolu 220mm	MS doublesocket 3/4"
7	Pina diffüzör	Pina diffuser	23	Pina dişli manşon 3/4"	MS lateral 220 mm
a	Pina diffüzör gövdesi	Pina diffuser body	24	MS kollektör	MS collector
b	Pina diffüzör kapağı	Pina diffuser lid	a	Pina kollektör kapağı	Pina collector lid
8	MS diffüzör tesisatı	MS diffuser pipe system	b	Pina kollektör civatası	Pina collector screw
9	Pina dıştan dişli adaptör d 63	Pina male threaded adapter d 63	c	Pina kollektör gövdesi	Pina collector body
10	MS üst rakor	MS upper union	25	MS hava tahliye borusu	MS air drain pipe
a	MS rakor gövdesi	MS union body - standart	26	MS filtre üst gövde	MS upper body of tank
b	MS rakor somunu	MS union nut - standart	27	MS kollektör ve kolları	MS collector with laterals
c	MS rakor O-ring	MS union O-Ring - standart	28	Filtre Kapak Civatası	Filter lid screw
11	MS üst rakor boru bağlantı	MS upperunion pipeconnection	29	Filtre çember (civatalı)	Filter circle (with screw)
12	MS üst rakor-adaptör bağlantı kiti	MS upper union-adapter kit	30	Filtre çember contası	Filter circle gasket
13	Altı yollu vana	Multiways valves	31	Filtre çember somunu	Filter circle and water
14	Altı yollu vana alt bağlantı parçası	MS valve connections pipe	32	Filtre drenaj tapası	Filter draining plug
15	MS alt rakor boru bağlantı	MS lower pipe connection piece			
16	MS alt rakor	MS lower union			
a	MS rakor gövdesi	MS union body			
b	MS rakor somunu	MS union nut			
c	MS rakor O-ring	MS union O-ring			

No	D 450mm - 18"		D 600mm - 24"		D 650mm - 26"		D 760mm - 30"		D 800mm - 32"		D 900mm - 36"		D 950mm - 38"		Adet
	Kod	Fiyat	Kod	Fiyat	Kod	Fiyat	Kod	Fiyat	Kod	Fiyat	Kod	Fiyat	Kod	Fiyat	
1	ZZU39	17,00	ZZU39	17,00	ZZU39	17,00	ZZU39	17,00	ZZU39	17,00	ZZU39	17,00	ZZU39	17,00	1
2	ZZU38		ZZU38		ZZU38		ZZU38		ZZU38		ZZU38		ZZU38		1
3	HTA01	0,20	HTA01	0,20	HTA01	0,20	HTA01	0,20	HTA01	0,20	HTA01	0,20	HTA01	0,20	10
4	HTP03	0,30	HTP03	0,30	HTP03	0,30	HTP03	0,30	HTP03	0,30	HTP03	0,30	HTP03	0,30	10
5	HTA02	21,00	HTA02	21,00	HTA02	21,00	HTA02	21,00	HTA02	21,00	HTA02	21,00	HTA02	21,00	1
6	HTP04	2,40	HTP04	2,40	HTP04	2,40	HTP04	2,40	HTP04	2,40	HTP04	2,40	HTP04	2,40	1
7	HTA03	8,30	HTA03	8,30	HTA03	8,30	HTA03	8,30	HTA03	8,30	HTA03	8,30	HTA03	8,30	1
a	HTA04	5,00	HTA04	5,00	HTA04	5,00	HTA04	5,00	HTA04	5,00	HTA04	5,00	HTA04	5,00	-
b	HTA05	3,30	HTA05	3,30	HTA05	3,30	HTA05	3,30	HTA05	3,30	HTA05	3,30	HTA05	3,30	-
8	AAA18	5,00	HTB01	10,00	HTB02	10,50	HTB03	10,50	HTB03	10,50	HTB04	11,00	HTB05	11,00	1
9	ELA02	1,30	ELA02	1,30	ELA02	1,30	ELA02	1,30	ELA02	1,30	ELA02	1,30	ELA02	1,30	2
10	EKA36	4,90	EKA36	4,90	EKA36	4,90	EKA37	4,95	EKA37	4,95	EKA37	4,95	EKA37	4,95	-
a	HTA08	1,80	HTA08	1,80	HTA08	1,80	HTA08	1,80	HTA08	1,80	HTA08	1,80	HTA08	1,80	1
b	HTA09	1,40	HTA09	1,40	HTA09	1,40	HTA09	1,40	HTA09	1,40	HTA09	1,40	HTA09	1,40	1
c	HTP05	0,40	HTP05	0,40	HTP05	0,40	HTP05	0,40	HTP05	0,40	HTP05	0,40	HTP05	0,40	1
11	HTA10	0,40	HTA10	0,40	HTA10	0,40	HTA11	0,50	HTA11	0,50	HTA11	0,50	HTA11	0,50	1
11	HTA30	0,40	HTA30	0,40	HTA30	0,40	HTA31	0,50	HTA31	0,50	HTA31	0,50	HTA31	0,50	1
12	HTB06	6,10	HTB06	6,10	HTB06	6,10	HTB07	6,60	HTB07	6,60	HTB07	6,60	HTB07	6,60	-
13	AAZ01	49,00	AAZ01	49,00	AAZ01	49,00	AAZ02	79,00	AAZ02	79,00	AAZ02	79,00	AAZ02	79,00	1
14	AAA18	5,00	AAA18	5,00	AAA18	5,00	AAA19	6,00	AAA19	6,00	AAA19	6,00	AAA19	6,00	1
15	YOK		YOK		YOK		HTA12	0,30	HTA12	0,30	HTA12	0,30	HTA12	0,30	1
16	HTA13	3,60	HTA13	3,60	HTA13	3,60	HTA14	3,90	HTA14	0,30	HTA14	3,90	HTA14	3,90	-
a	HTA08	1,80	HTA08	1,80	HTA08	1,80	HTA08	1,80	HTA08	3,90	HTA08	1,80	HTA08	1,80	1
b	HTA09	1,40	HTA09	1,40	HTA09	1,40	HTA09	1,40	HTA09	1,80	HTA09	1,40	HTA09	1,40	1
c	HTP05	0,40	HTP05	0,40	HTP05	0,40	HTP05	0,40	HTP05	1,40	HTP05	0,40	HTP05	0,40	1
17	HTP06	1,40	HTP06	1,40	HTP06	1,40	HTP06	1,40	HTP06	0,40	HTP06	1,40	HTP06	1,40	2
18	HTB08	5,70	HTB08	5,70	HTB08	5,70	HTB09	6,00	HTB09	1,40	HTB09	6,00	HTB09	6,00	-
19	HTB10	10,00	HTB10	10,00	HTB11	11,00	HTB12	11,30	HTB12	6,00	HTB13	12,00	HTB14	12,50	1
20	HTA15	105,00	HTA15	105,00	HTA16	115,00	HTA38	0,00	HTA17	11,30	HTA18	220,00	HTA19	235,00	1
21	AAA28	1,30	AAA15	1,30	AAA15	1,30	AAA15	1,30	AAA15	175,00	AAA15	1,30	AAA15	1,30	12
22	YOK		AAA16	1,40	AAA16	1,40	AAA16	1,40	AAA16	1,30	AAA16	1,40	AAA16	1,40	12
23	YOK		AAA17	1,20	AAA17	1,20	AAA17	1,20	AAA17	1,40	AAA17	1,20	AAA17	1,20	12
24	HTA20	11,80	HTA20	11,80	HTA20	11,80	HTA20	11,80	HTA20	1,20	HTA20	11,80	HTA20	11,80	1
a	HTA21	3,00	HTA21	3,00	HTA21	3,00	HTA21	3,00	HTA21	11,80	HTA21	3,00	HTA21	3,00	-
b	HTP07	0,30	HTP07	0,30	HTP07	0,30	HTP07	0,30	HTP07	3,00	HTP07	0,30	HTP07	0,30	-
c	HTA22	9,00	HTA22	9,00	HTA22	9,00	HTA22	9,00	HTA22	0,30	HTA22	9,00	HTA22	9,00	-
25	HTP08	2,30	HTP08	2,30	HTP09	2,50	HTP10	2,90	HTP10	9,00	HTP11	3,00	HTP12	3,10	1
26	HTA23	100,00	HTA23	100,00	HTA24	115,00	HTA39	0,00	HTA25	2,90	HTA26	225,00	HTA27	235,00	1
27	HTA28	27,00	HTA28	27,00	HTA28	27,00	HTA29	44,00	HTA29	175,00	HTA29	44,00	HTA29	44,00	-
29	ZWZ63	12,00	ZWZ63	12,00	ZWZ63	12,00	ZWZ63	12,00	ZWZ63	44,00	ZWZ63	12,00	ZWZ63	12,00	1
30	ZWZ19	4,00	ZWZ19	4,00	ZWZ19	4,00	ZWZ19	4,00	ZWZ19	12,00	ZWZ19	4,00	ZWZ19	4,00	1
31	MWP02	0,00	MWP02	0,00	MWP02	0,00	MWP02	0,00	MWP02	4,00	MWP02	0,00	MWP02	0,00	10
32	ZZU18	0,00	ZZU18	0,00	ZZU18	0,00	ZZU18	0,00	ZZU18	0,00	ZZU18	0,00	ZZU18	0,00	1